



INDICATES SUITE ADDRESS NUMBERS (ON BELL MILL RD., RED BLUFF, CA 96080)

BUILDING AREA:	NET
MAIN BLDG.:	94,709 SF (INCL. ANCHOR 'B' MEZZ.)
PAD 'A'	3,877 SF
PAD 'B'	4,050 SF
PAD 'C'	10,765 SF
PAD 'D'	8,191 SF
TOTAL:	121,592 SF

LAND AREA: 410,624 SF

LEASE PLAN
0.0A EXISTING

11/16/16 sp/ab

C:\PROJECTS\ BELLE
MILL & EAST

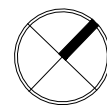

0 40' 80' 160'

PARKING PROVIDED: 426 (14 H/C, NO COMPACTS, RATIO: 1:285)

ZONE / COMM. PLAN: C
GENERAL PLAN: COMMERCIAL

T. W. LAYMAN ASSOCIATES
EXISTING PLAN INFORMATION FROM SURVEY &
AS-BUILT MEASUREMENTS BY OTHERS. NOT
REVIEWED WITH GOVERNMENTAL AGENCIES.

BELLE MILL LANDING SHOPPING CENTER
RED BLUFF, CA

U.S. REALTY PARTNERS, INC.

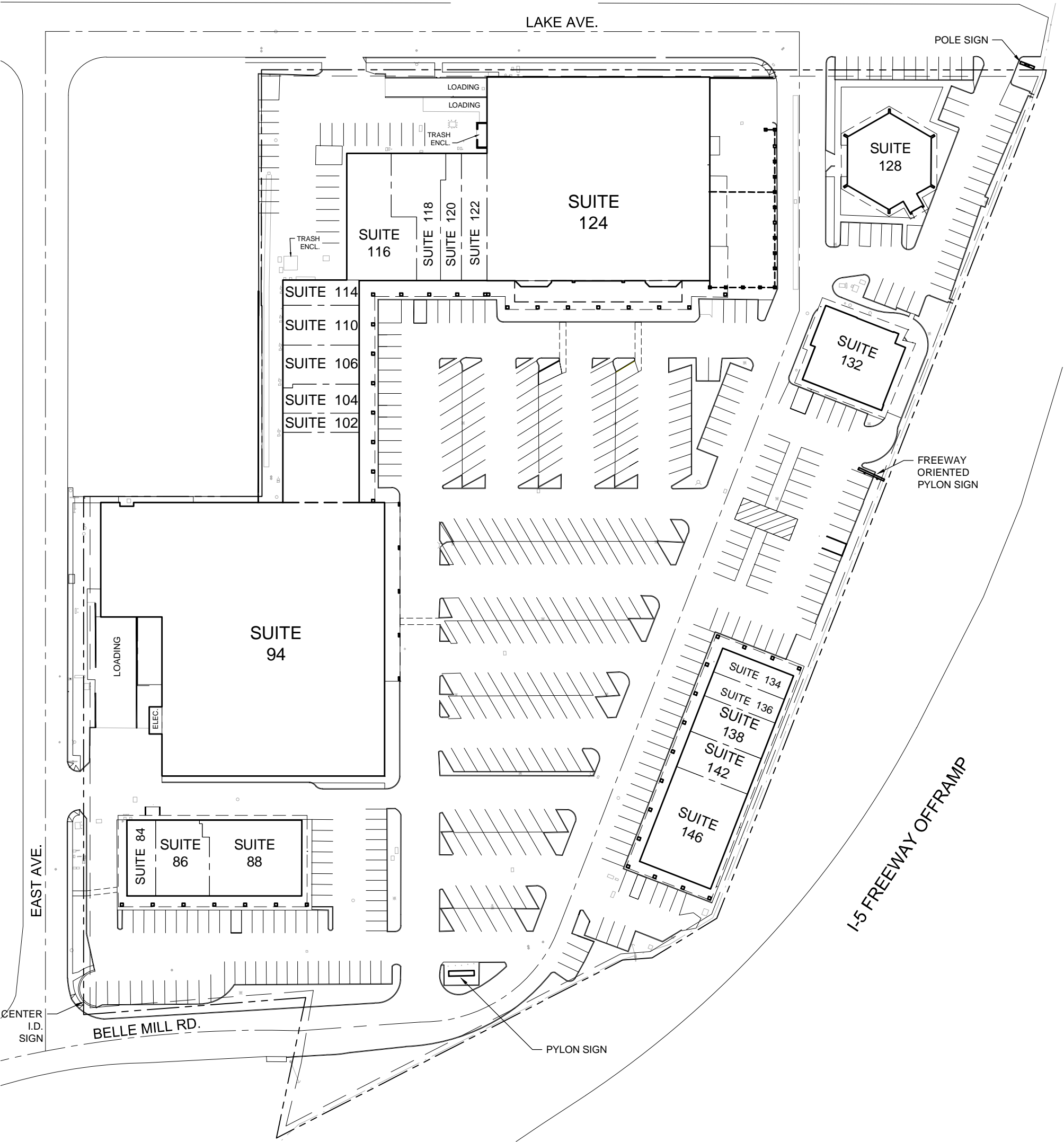

SITE PLAN

11/16/16

